



# Southwest Seventh

DEPARTMENT OF TRANSPORTATION HEADQUARTERS BUILDINGS

No. 82

May 15, 1973



## Seven things

**you should know about  
U.S. Savings Bonds**



TAKE STOCK IN AMERICA  
JOIN THE PAYROLL SAVINGS  
PLAN

1. Series E Bonds pay off at a great rate—5½ % interest, compounded semiannually, when held to maturity of 5 years 10 months (4% the first year). Principal and interest are fully guaranteed.
2. Your interest is not subject to state or local income or personal property taxes—which means an even bigger return on your investment.
3. Bonds are liquid—redeemable at any time after two months.
4. If your Bonds are lost, stolen, or destroyed, they will be replaced without charge.
5. An education or retirement plan built with Bonds can offer special tax savings. (See other side).
6. Buying Bonds regularly helps your country . . . builds your own financial security.
7. And buying them regularly is the easiest thing in the world—through the painless, automatic Payroll Savings Plan.



## SECRETARY BRINEGAR ISSUES STRONG POLICY STATEMENT ON CIVIL RIGHTS

On Friday, April 27, 1973, in a formal session attended by representatives of the White House and DOT officials, Secretary Brinegar issued the following strong DOT policy statement on civil rights.

"I have long endorsed the policy of the Federal Government that the protection of each citizen's civil rights is of highest priority and no person should be denied equal opportunity in our society because of race, color, sex, religion or national origin.

As Secretary of Transportation, I pledge my complete support to this policy and I shall insist on adherence to it in the performance of all the Department's actions.

It is not sufficient for us to be content merely to observe the law and implement public policy. Our efforts and actions must be positive and effective to improve the status of minority group persons and women.

I am requiring that this principle be rigidly followed. Our efforts to achieve equal opportunity shall be second to none."

## ANNUITY INCREASE EFFECTIVE JULY 1, 1973, A REAL POSSIBILITY

The Civil Service Retirement Law provides for the automatic increase of Civil Service Annuities when the cost of living nationwide goes up by at least three percent over the Consumer Price Index (CPI) for the month used as the base for the last annuity increase, and stays that high for three consecutive months. The February and March 1973 cost of living increases exceeded the CPI over base month (April 1972) by 3.5% and 4.4% respectively. If the Cost of Living stays at or above 3.0% during April 1973, annuities will be increased for all retirees and those employees who retire by June 30, 1973, by at least 5.4% (includes an additional 1% provided by law). This information probably will not be available until the last week in May 1973.

If you are planning to retire, on or before June 30, 1973, you are urged to contact your personnel office early for retirement planning purposes and counseling.

Applicants with pending disability retirement cases should request the agency to place them on leave without pay, on or before July 1, 1973, to qualify for the tentative annuity increase. If the disability claim is disallowed, sick or annual leave with pay may be substituted retroactively for the leave without pay. If the claim is allowed, accumulated annual leave will be payable in a lump sum and sick leave will be allowed in computing the annuity rate.

## SEQUENCE OF MOVES TO THE BUZZARD POINT BUILDING

The moving operations are planned for week-ends to keep the disruption of normal activities to a minimum. It is presently planned to begin the moves over the week-end of May 18. Should there be a delay for any reason, the whole schedule will be slipped forward a week or so as necessary; however, the sequence should remain the same.

### Proposed Schedule

<u>Move Date</u>		<u>Organization</u>
5/18/73	OST	Cost Allocation Study Group Hazardous Materials. Pipeline Safety. Climatic Impact Assessment. Support Services (mail room and facilities scheduling services.
6/1/73	FRA	Office of Research, Development and Demonstrations. Office of Safety.
6/1/73	NHTSA	Research Institute-- Information Systems Division. Motor Vehicle Programs. Office of Standards Enforcement.
6/8/73	USCG	Office of Boating Safety
6/8/73	FAA	
6/15/73	FAA	
6/22/73	FAA	
6/29/73	FAA	
7/6/73	UMTA	and FHWA

### RETURN OF FILE

The file of U.S. Coast Guard Interagency Agreements in a black three ring binder was borrowed some time ago from TAD-60. Will the borrower please either return it to room 9100 or advise TAD-60 (x64237) as to where it is and when it will be returned?



ANACOSTIA RIVER



PARKING AREA

STORAGE ROOM  
FOR PAINT, OIL,  
Etc.

CLUBHOUSE  
BOILER

1<sup>st</sup> Street

2<sup>nd</sup> Street

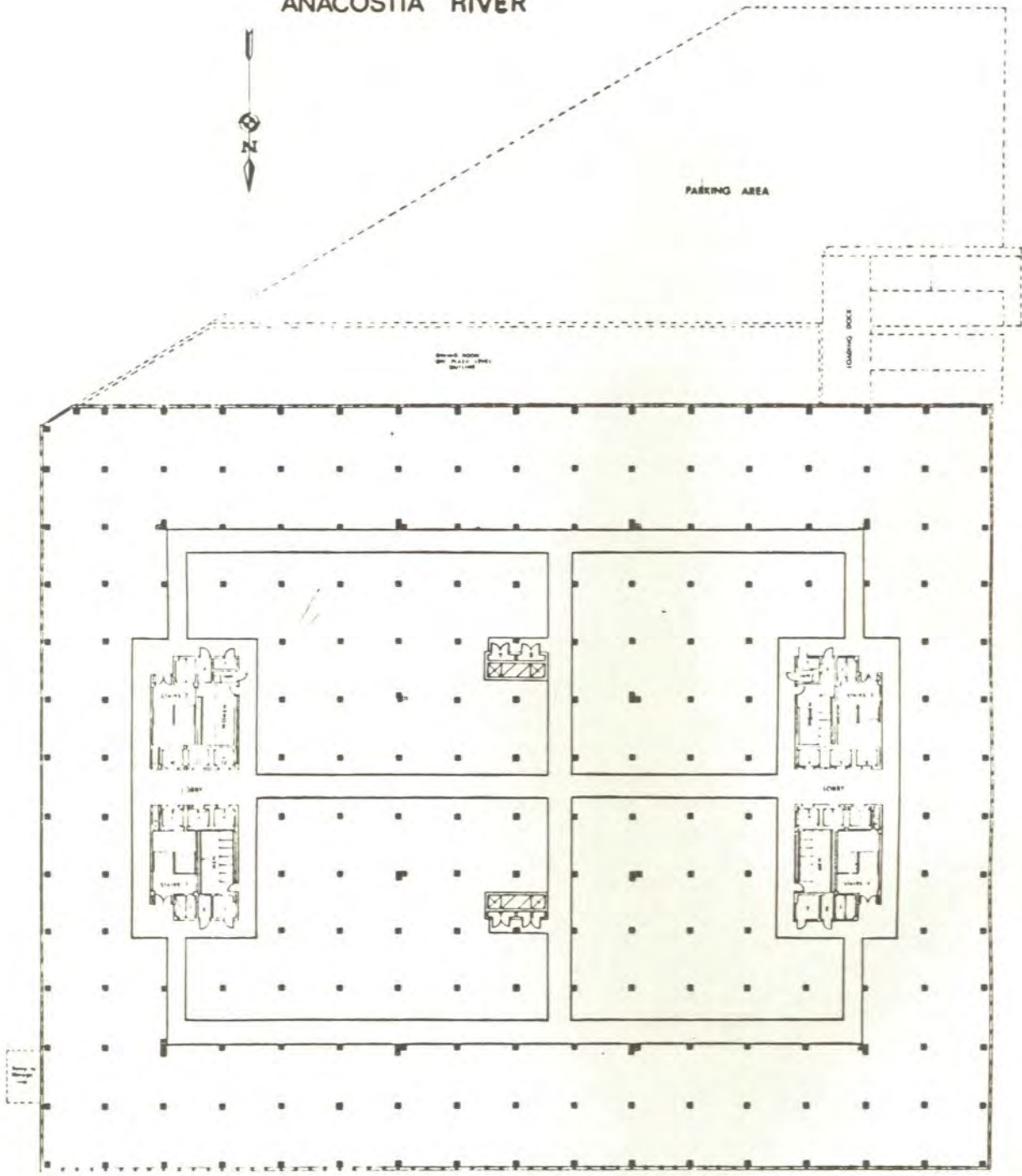

TYPICAL FLOOR  
PLAN

V Street

BULLARD'S POINT  
2100 2<sup>nd</sup> ST SW  
Washington, D.C.

Typical floor layout showing main corridors and  
elevator / rest room / stairwell cores at either end of building.

## NATIONAL TRANSPORTATION WEEK FILM

To mark National Transportation Week, a special tape depicting transportation in America will be shown in the FOB-10A auditorium this week. Show times are 12 noon and 12:30 p.m., on Tuesday, May 15 and Friday, May 18.

## HEALTH FACILITY AT BUZZARD POINT

The USCG informs us that the health facility at Buzzard Point will be operated as a satellite of the DOT Headquarters Building Clinic. The basic program will be similar to those conducted at most civilian health units where basic treatment is provided for on-the-job illness, injuries on the job and such other services that the staff is capable of supplying. At this time it is not contemplated that a physician will be in attendance but the facility will be staffed by at least two and ultimately three nurses. The Executive Physical Program will be conducted for participating DOT employees at the DOT Headquarters Building Clinic.

## LIBRARY SERVICES - BUZZARD POINT BUILDING

At present, there are no plans to move any of the DOT Library collection to the Buzzard Point Building. Service will be provided from the existing locations. Reference assistance will be available by telephone and publications may be requested and delivered by the regular mail service which runs several times a day between the DOT Buildings. There also is frequent shuttle bus service between buildings for those who prefer to visit the library personally.

It should be noted that some of the publications held by the FOB-10A technical library are duplicated in office collections which will be moving to the Buzzard Point location. AAF maintains a quite comprehensive collection of federal, military and FAA specifications. In addition, some AAF and ARD offices have been receiving various military publications on regular distribution from the library. This service will continue, and other offices may wish to request similar arrangements. The Logistics Service, rather than the DOT Library, has been maintaining the "contract library." These files will go to Buzzard Point along with the office responsible for maintaining them.

## OFFICE SUPPLIES - BUZZARD POINT

GSA has, so far, declined our requests to open a store in the Buzzard Point Building. Efforts are continuing to convince them of our need and we hope eventually to have at least part-time service there. Meanwhile, occupants of the Buzzard Point Building will need to shop for their supplies at existing GSA store locations. Bundles of supplies may be marked with your name and room number and left at the FOB-10A or Headquarters Building GSA store for delivery to your office by mail service.





# SHUTTLE BUS SCHEDULE

Leave FOB-10A *	Leave HQ Bldg.**	Arrive Buzzard Pt.***	Leave Buzzard Pt. ***	Leave HQ Bldg.(* )	Arrive FOB-10A (**)
<u>DOT Bus</u>					
7:00 a.m.	7:06 a.m.	7:13 a.m.	7:00 a.m.	7:07 a.m.	7:13 a.m.
7:15	7:21	7:28	7:15	7:22	7:28
7:30	7:36	7:43	7:30	7:37	7:43
7:45	7:51	7:58	7:45	7:52	7:58
8:00	8:06	8:13	8:00	8:07	8:13
8:15	8:21	8:28	8:15	8:22	8:28
<u>DOD Bus</u>					
8:29	8:35	8:43	8:24	8:31	8:38
8:59	9:05	9:13	8:54	9:01	9:08
9:29	9:35	9:43	9:24	9:31	9:38
9:59	10:05	10:13	9:54	10:01	10:08
10:29	10:35	10:43	10:24	10:31	10:38
10:59	11:05	11:13	10:54	11:01	11:08
11:29	11:35	11:43	11:24	11:31	11:38
11:59	12:05	12:13	11:54	12:01	12:08
12:29	12:35	12:43	12:24	12:31	12:38
12:59	1:05	1:13	12:54	1:01	1:08
1:29	1:35	1:43	1:24	1:31	1:38
1:59	2:05	2:13	1:54	2:01	2:08
2:29	2:35	2:43	2:24	2:31	2:38
2:59	3:05	3:13	2:54	3:01	3:08
3:29	3:35	3:43	3:24	3:31	3:38
3:59	4:09	4:13	3:54	4:01	4:08
<u>DOT Bus</u>					
4:15	4:21	4:28	4:15	4:22	4:28
4:30	4:36	4:43	4:30	4:37	4:43
4:45	4:51	4:58	4:45	4:52	4:58
5:00	5:06	5:13	5:00	5:07	5:13
5:15	5:21	5:28	5:15	5:22	5:28
5:30	5:36	5:43	5:30	5:37	5:43
5:45	5:51	5:58	5:45	5:52	5:58
6:00	6:06	6:13	6:00	6:07	6:13

\* FOB-10A driveway - Independence Ave.

\*\* North side of "E" street at southwest corner of building.

\*\*\* Adjacent to the "V" street entrance to the building.

(\*) South side of "E" street across from southwest corner of HQ Building.

(\*\*) North side of Independence Ave. opposite FOB-10A.





Artist's rendition of completed Buzzard Point Building (2100 Second St., S.W.)